



# Co-op News from Wyrulec Company

Your Touchstone Energy® Cooperatives   
The power of human connections

February 2011

\*John Gifford Jr\*

## How to reach us

Wyrulec Company  
500 Main St. • PO Box 359  
Lingle, Wyoming 82223  
307-837-2225  
800-628-5266  
Fax: 307-837-2115

E-mail: [wyrulec@wyrulec.com](mailto:wyrulec@wyrulec.com)

Website: [www.wyrulec.com](http://www.wyrulec.com)

Office hours: 7:30 am–4:30pm

## Board of Directors

Dewey Hageman  
*President*

Julie Kilty  
*Vice President*

F.E. "Wally" Wolski  
*Secretary*

Brent Mullock  
*Treasurer*

Jack Preston  
*Assistant Secretary*

Joanne L Franks  
*Winner*

## General Manager

Rollie Miller

## Senior Staff

Joe Kinnan  
*Operations Manager*

Cindy Potter  
*Office Manager*

## From your manager



Miller

## Oil activity

We continue to see service requests for serving the oil exploration loads near Veteran, Wyo. To date we have received 10 new three-phase service requests: two at 75kVA, six at 300kVA and two at 600kVA. The two larger-size requests are for oil pipeline compressor stations. To get an idea of the size of these new loads, the Southeast school is about a 200-300 kVA load for us. \*Donald R Cearns Sr\* The Veteran area is served by our Veteran Substation located near the Gun Club and the Yoder Substation located along Hwy. 85 near Yoder. We have available capacity on those two stations for about 10 new 300 kVA loads. My point with all of this is that if the oil "boom" hits we will need to construct additional delivery capability and soon. We have initiated the planning process with our power supplier, Tri-State Generation and Transmission, for acquiring a totally new delivery point located north and west of Veteran. We will keep you informed as we move forward with these plans. As an interesting side note, we have been approached by a oil "landman" about selling the mineral rights located under our substations and other property.

able capacity on those two stations for about 10 new 300 kVA loads. My point with all of this is that if the oil "boom" hits we will need to construct additional delivery capability and soon. We have initiated the planning process with our power supplier, Tri-State Generation and Transmission, for acquiring a totally new delivery point located north and west of Veteran. We will keep you informed as we move forward with these plans. As an interesting side note, we have been approached by a oil "landman" about selling the mineral rights located under our substations and other property.

## New headquarters

The board of directors, at their November board meeting, approved the purchase of eight acres of land immediately behind and adjacent to our substation and pole yard along Hwy. 26 west of Torrington. The additional land increases the amount of property we own there to about 11 acres. The board has been discussing replacement of the existing headquarters for over three years at every meeting and this decision was a major milestone. Baker and Associates have provided site and building drawings throughout the last year and a half and I think we are finally landing on a plan that allows for future expansion while meeting the current needs. \*Sandy L Buford\* The existing headquarters building was constructed in 1951 and the cooperative has grown to where the current facility no longer meets our needs. Stay tuned for further details related to this.

## Annual meeting

We hope you plan to attend the annual meeting scheduled for March 29th at the Rendezvous Center. It will be our 75th Annual Meeting and we will be discussing how to serve the needs of the members for at least the start of the next 75 years.

As always if you need to contact me feel free to call the office or you can reach me on my wireless almost anytime at (307) 575-2435. My email is [rmiller@wyrulec.com](mailto:rmiller@wyrulec.com).



# Environmental umpire

As a big baseball fan, sometimes I'm upset by an umpire's decision. I know umps are needed to enforce rules of the game, but I've seen quite a few blown calls in my time.

In many ways, umpire mistakes mirror what's going on with government regulation regarding electric utilities and electricity production. The U.S. Environmental Protection Agency (EPA) writes the rulebook for power suppliers like Tri-State Generation and Transmission Association (our power supplier), and EPA also serves as an umpire, enforcing the rules of the game.

### Keeping rates as low as possible

At Wyrulec Company, we're committed to keeping your electric bill affordable. So you can understand why I get upset when I see EPA folks make bad calls that put pressure on how much you pay for power.

Over the past two years, Congress debated, but never passed, a comprehensive climate change bill. Into this void, EPA has stepped forward and has now fielded a team of new regulations. Out of these "players," three could hit electric bills out of the park.

 Clean Air Transport Rule: This rule kicks in

next year and aims to cap power plant emissions of sulfur dioxide and nitrogen oxides from state to state between 31 eastern states and the District of Columbia. By 2014, EPA claims the rule, when combined with other state and federal measures (such as Maximum Achievable Control Technology, or MACT, rules for mercury emissions), will reduce sulfur dioxide emissions from power plants by 71 percent and nitrogen oxides emissions by 52 percent from 2005 levels, but it will cost utilities \$2.8 billion every year to comply.

 Cooling Water Intake Requirements: Power plants use water from lakes or rivers to cool generating equipment. While screens and various components prevent fish and other wildlife from entering water intake pipes, EPA thinks this equipment could be improved. We're expecting a rule proposal this month, and the impact could be severe. The North American Electric Reliability Corporation (NERC), the nation's bulk power

*Hot food, warm laughter, cash prizes, interesting history*

You won't want to miss this year's annual meeting, remember how much fun we had last year?

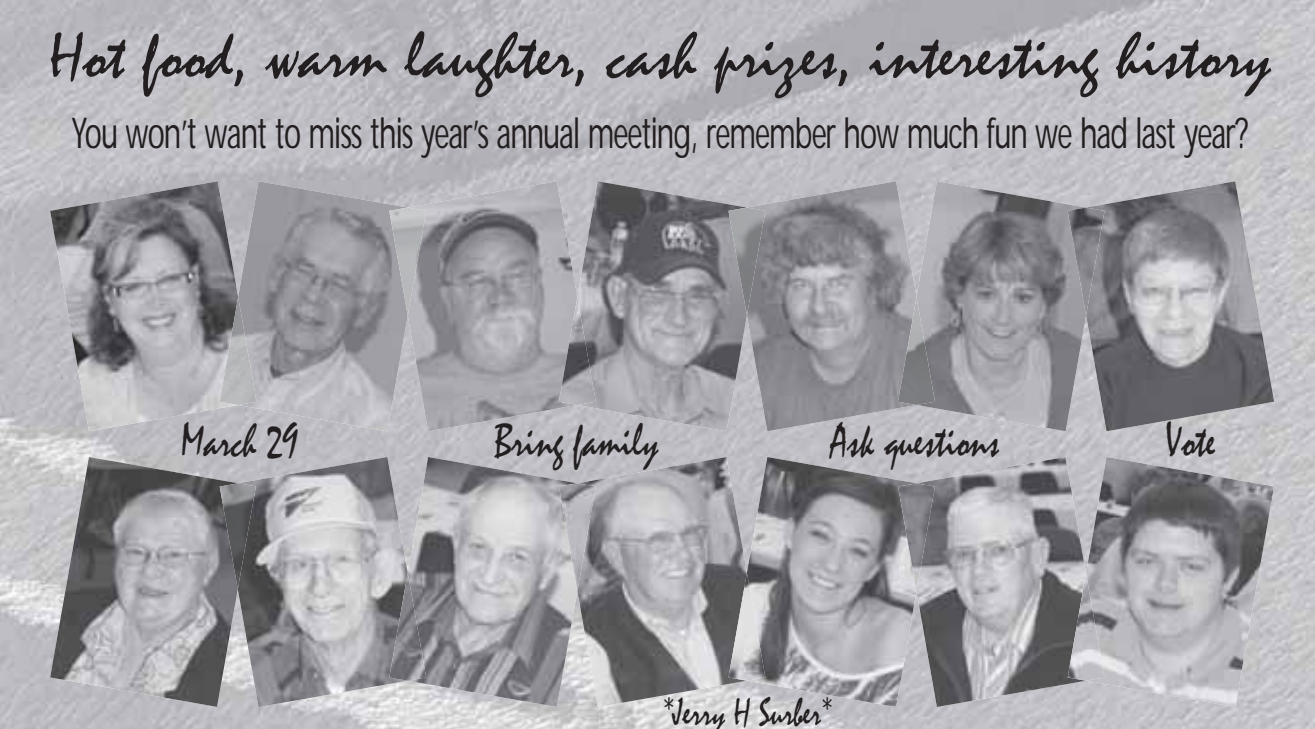

*March 29*      *Bring family*      *Ask questions*      *Vote*

*\*Jerry H Surber\**

## making bad calls

grid watchdog, claims if this rule is strictly enforced, one-third of U.S. electricity capacity may need to be retired.

✂️ **Coah Ash:** To ensure the safe disposal of fly ash and other residues (bottom ash, scrubber sludge, and slag) produced by coal-fired power plants (known as coal combustion residuals, or CCRs), EPA is considering whether or not to designate the materials-for the first time-as hazardous waste. Complying with this rule could cost billions and would also halt recycling efforts. Right now we use one-third of all fly ash as a Portland cement substitute-and for every ton of concrete replaced by fly ash, a ton of greenhouse gas emissions is avoided. On four prior occasions-most recently under the Clinton

Administration in 2000-EPA determined CCRs do not warrant regulation as a hazardous waste. Not only did EPA find CCRs rarely, if ever, exhibit a hazardous waste characteristic, the agency also concluded states can safely manage CCRs under federal non-hazardous waste rules.

Wyrulec Company is committed to keeping you informed about government regulations that will increase the cost of electricity. We're joining co-ops nationally to ask Congress for a much-needed time-out-a two-year moratorium on EPA regulation of carbon dioxide greenhouse gases. A delay would give lawmakers the opportunity to fashion climate change legislation that protects you, our consumers, and keeps electric bills affordable.

Source: NRECA

# A "two-pronged" approach to electrical safety

By CHRISTINE SMITH

Consumers can depend on a pair of important safety devices to protect them from electrical hazards in the home: ground fault circuit interrupters (GFCIs) and arc fault circuit interrupters (AFCIs). Each device protects against different dangers: GFCIs address shock hazards while AFCIs fight fire hazards.

## Get grounded!

According to the Electrical Safety Foundation International (ESFI), GFCIs have cut the number of home electrocutions by half. By detecting ground faults—an unintentional electric path between a source of current and a grounded surface; essentially, current leaking to the ground—a GFCI protects you from severe or fatal electric shocks. It can also prevent some electrical fires.

If you have ever experienced an electric shock, it probably happened because part of

*Continued on page 4*

### How to test electrical outlets

Since the 1970s ground fault circuit interrupters (GFCIs) have saved thousands of lives, helping cut the number of home electrocutions in half. The safety devices prevent deadly shock by quickly shutting off power to the circuit if the electricity flowing into the circuit differs from the amount returning. The safety devices should be used in any indoor or outdoor area where water may come into contact with electrical products.

GFCIs should be tested once a month to make sure they're working properly. To test a device, follow these four steps:

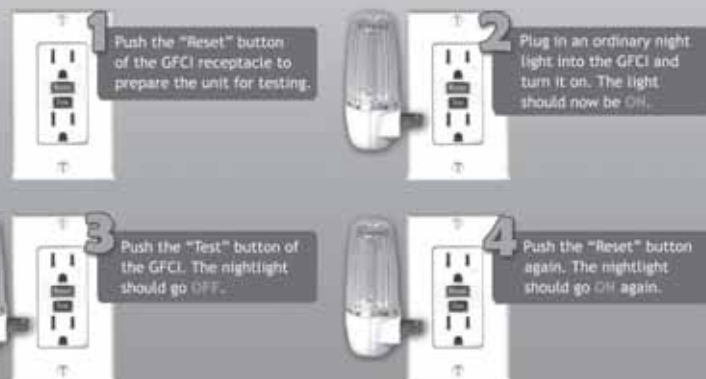

Source: Electrical Safety Foundation International

## A “two-pronged” approach to electrical safety

*Continued from page 3*

your body contacted an electrical current and provided a path for the current to go to ground. If your body provides the path, you could be seriously injured.

GFCIs constantly monitor electricity moving through a circuit. If the current flow differs from that returning, the device quickly switches off power.

### Fighting fire

AFCIs, a relatively recent technology, help prevent home fires caused by arcing faults in damaged or deteriorated wires and cords. Home wiring problems, like sparking, are associated with more than 40,000 home fires each year, according to the Consumer Product Safety Commission. These fires kill more than 350 and injure 1,400 victims annually.

Nominal arcs may happen in the brushes of a vacuum sweeper or light switch; dangerous arcs can occur in

frayed cords. When unwanted arcing occurs, it generates high temperatures that can ignite nearby combustibles such as wood, paper, and carpets.

Conventional circuit breakers only respond to overloads and short circuits. By the time a fuse or circuit cuts power to defuse these conditions, a fire may have already started. AFCIs use unique current-sensing circuitry to discriminate between normal and unwanted arcing conditions. In the event of an arcing fault, the AFCI shuts off electricity flowing through a circuit. For more information on where to install GFCIs and AFCIs, visit [www.cpsc.gov](http://www.cpsc.gov).

Sources: Electrical Safety Foundation International, Consumer Protection Safety Commission

*Christine Smith writes on electrical safety for the Nat'l Rural Electric Co-op Assn., the Arlington, Va.-based service arm of the nation's 900-plus consumer-owned, not-for-profit electric cooperatives.*

## Old refrigerators eat energy and money

Does this sound familiar? You bought a new refrigerator and moved your old fridge to a garage or basement to keep a few drinks and some surplus food items cold. Here's a tip from Wyrulec Company that can help you save energy and money.

Old refrigerators, especially those bought before 1993, use more than twice as much electricity as a new ENERGY STAR model. What's more, refrigerants in these older appliances

weaken over time and door seals start to leak, causing a decline in the performance.

If you have moved your old refrigerator to an uninsulated location, such as a garage, it will use even more energy during hot weather. A fridge in a 90 degree environment, for example, uses nearly 50 percent more power than one in a 70 degree environ-

ment. And if the temperature falls below about 40 degrees in winter, the refrigerator's thermostat may not run its cooling and defrost cycles for the appropriate amount of time.

By pulling the plug on that old refrigerator, you can save \$146 a year. For other tips on how to save energy—and money—visit [www.energysavers.gov](http://www.energysavers.gov) or Touchstone Energy® Cooperatives energy-saving website, [www .TogetherWeSave.com](http://www.TogetherWeSave.com) or call the efficiency experts at Wyrulec Company at 800-628-5266 or 307-837-2225.



### ❁ Illuminating Sweethearts ❁

We have CFLs in stock that are 100-watt replacements. They will fit into any light fixture rated over 23 watts (anywhere a 60- to 100-watt incandescent bulb is now). They operate at 23 watts but provide Valentine's Day sparkle equal to a 100-watt incandescent. They are \$1.00 each.

### All those Valentines

Each month, we hide the names of five members in this newsletter. If you see your name this month, please call and accept a \$25 Valentine from us.